

## Australian Mental Health Unit Design (presentation)

**Author:**

Carthey, Jane

**Event details:**

European Health Property Network (EuHPN) Design for Dementia Care  
Workshop  
Durham, UK

**Publication Date:**

2009

**DOI:**

<https://doi.org/10.26190/unsworks/1143>

**License:**

<https://creativecommons.org/licenses/by-nc-nd/3.0/au/>

Link to license to see what you are allowed to do with this resource.

Downloaded from <http://hdl.handle.net/1959.4/45590> in <https://unsworks.unsw.edu.au> on 2024-04-19



Centre for Health Assets Australasia

## EUROPEAN HEALTH PROPERTY NETWORK WORKSHOP 2009 Australian Mental Health Unit Design

**A/Prof Jane Carthey** - Director, Centre for Health Assets Australasia (CHAA)

Faculty of the Built Environment, University of New South Wales, Sydney, Australia

010101011110100100001  
0101101011100



**UNSW**  
THE UNIVERSITY OF NEW SOUTH WALES

**BUILT  
ENVIRONMENT**

Centre for Health Assets Australasia



# OUTLINE

1. Development of Australasian Health Facility Guidelines (AusHFG) Mental Health Unit – Healthcare Planning Units (HPU)
2. Mater Mental Health Unit Newcastle NSW



# **1. Australasian Health Facility Guidelines**

## **1. Development of Mental Health Unit – Healthcare Planning Units (HPU)**

- Acute adult including PICU currently under review
- Older People – being developed
- Child and Adolescent – review
- Non-acute - future
- PECC – already developed for NSW



# 1. Australasian Health Facility Guidelines

## Biggest issues include:

- Models of care – e.g. ‘recovery model’ – how does this translate to physical space?
- Outdoor space / courtyards – sqm per patient required
- Circulation space - % and total
- Detailing of fittings to prevent self harm including availability of commercial items
- Building budgets set too early to meet the project needs as subsequently defined



## **2. Mater Mental Health Unit Newcastle NSW**

Situated in Waratah, Newcastle – 2 hours north of Sydney

Previously a 'working class' town – steel mill (closed), major port (still operating);

Polluted – now greatly cleaned up; Newcastle Earthquake – 1989 (5.6 Richter Scale) caused extensive damage and several deaths.

Hospital commenced in 1921 with healthcare provided by the Sisters of Mercy (Singleton) for the people of Newcastle and surrounding areas - handed to The Sisters of the Little Company of Mary in 2006.

'Affiliated hospital' under the health services act – one of only two left in NSW

December 2005 – significant redevelopment initiated by NSW Health – Mix of traditional and PPP procurement.



010101011110100100001  
0101101011100



**UNSW**  
THE UNIVERSITY OF NEW SOUTH WALES

**BUILT  
ENVIRONMENT**

Centre for Health Assets Australasia



# Newcastle NSW





## 2. Mater Mental Health Unit Newcastle NSW

### Total project includes:

The redevelopment of the 180-bed Calvary Mater Newcastle;

Construction of a new 100-bed acute mental health facility on the Mater site – including 10 extra acute mental health beds - to replace existing facilities at Newcastle's James Fletcher Hospital;

An expansion of cancer radiation therapy facilities, including the construction of two extra bunkers and two linear accelerators and refurbishment of existing facilities;

An upgrade of existing facilities includes a new peri-operative suite comprising three operating theatres, day surgical unit and surgical inpatient facilities.

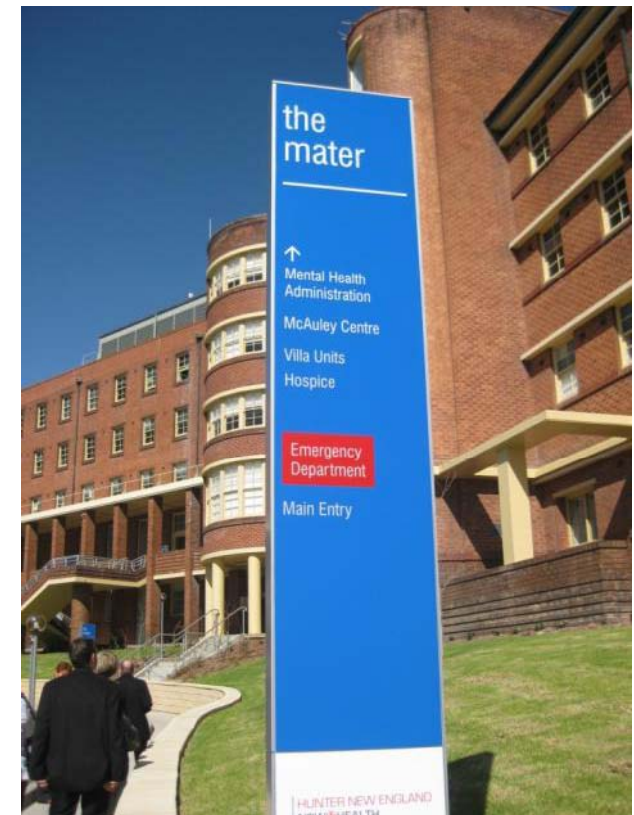





## 2. Mater Mental Health Unit Newcastle NSW

### NSW Health information:

The Mater PPP = schedule 3 – hospital redevelopment of 198 beds Medical, Surgical, Ambulatory Care, Emergency Department, Intensive care, and Integrated Cancer Services.

Largest number of Linac radiotherapy machines in NSW – with the redevelopment adding on a further 3 bunkers with high energy linac = 5 linac on site as well as OPD, chemotherapy suite and melanoma ambulatory care service plus Hospice and villa units .

Cancer services, Drug and Alcohol services.

The Breast Screening Service is managed by Hunter New England Health and run their service from Newcastle/Waratah up to Armidale.

**There is a 100 bed Acute Adult Mental Health inpatient unit, Ambulatory Care and Mental Health Administration Unit.** The Hunter New England Mental Health Services are administered from here with services again up to Armidale.

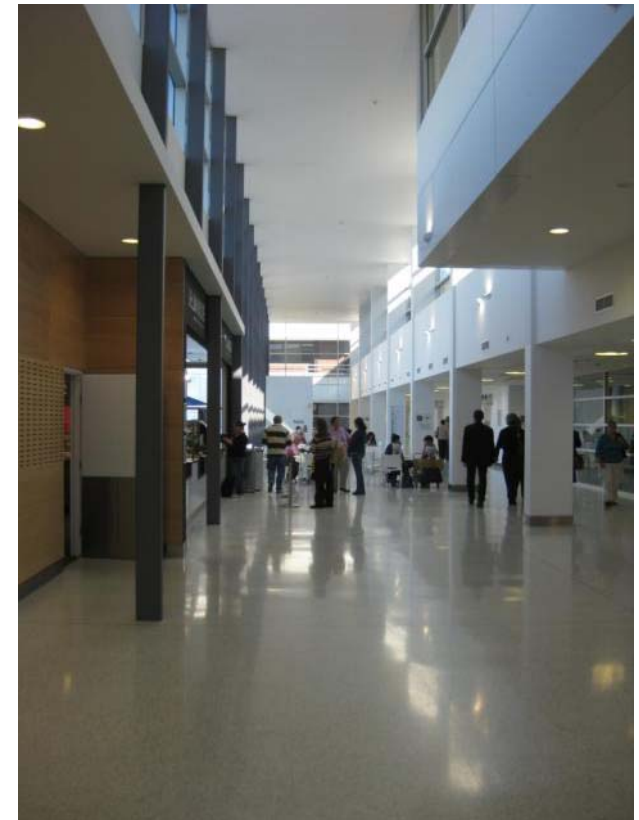



010101011110100100001  
0101101011100

UNSW  
f|b|e

Centre for Health Assets Australasia





010101011110100100001  
0101101011100



**UNSW**  
THE UNIVERSITY OF NEW SOUTH WALES

**BUILT  
ENVIRONMENT**

Centre for Health Assets Australasia



# Mater Mental Health Unit Newcastle NSW

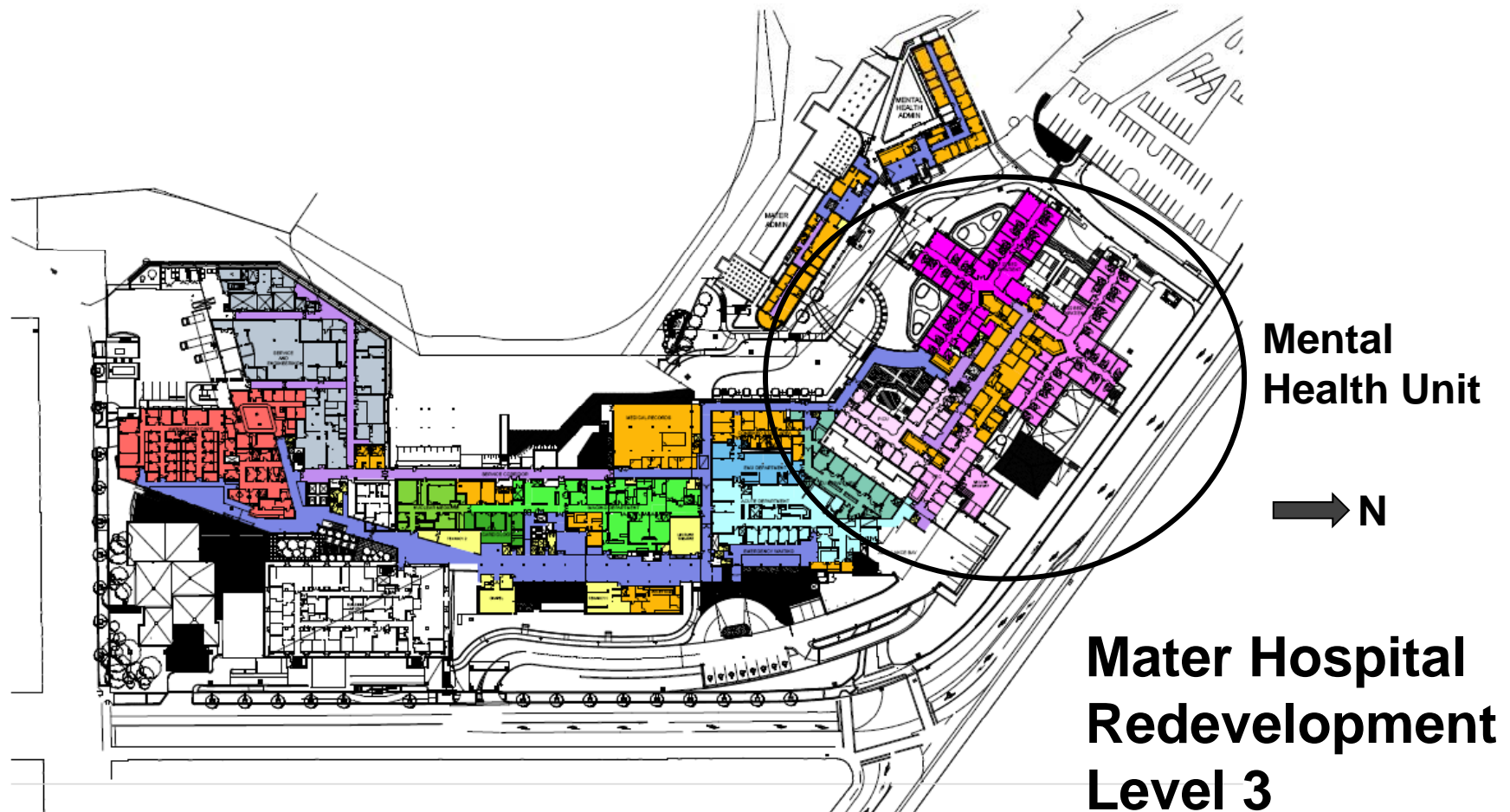

010101011110100100001  
0101101011100



**UNSW**  
THE UNIVERSITY OF NEW SOUTH WALES

**BUILT  
ENVIRONMENT**

Centre for Health Assets Australasia



# Mater Mental Health Unit Newcastle NSW

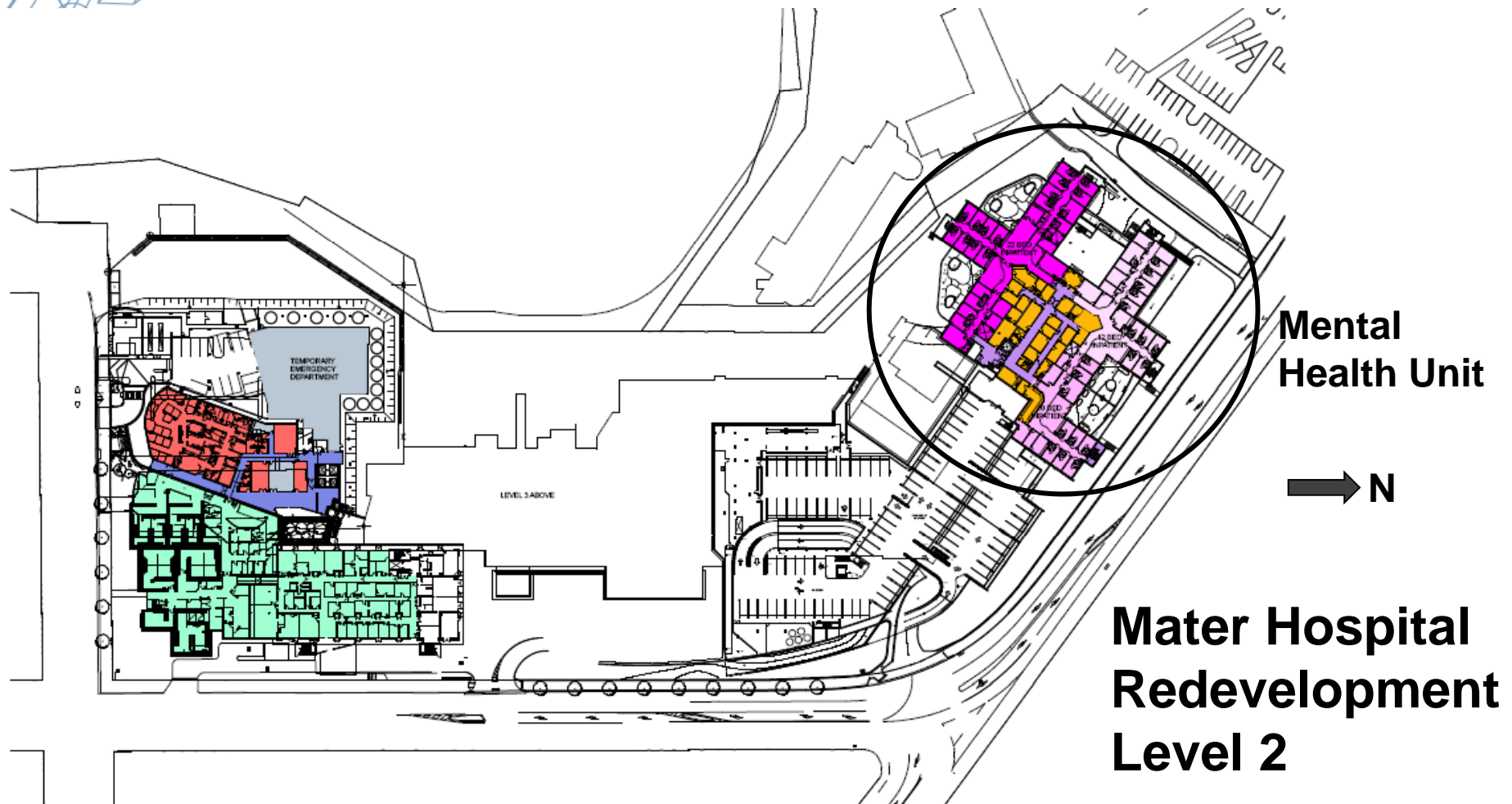



## 2. Mater Mental Health Unit Newcastle NSW

### Mental Health Unit:

PEC – 2 beds – closely linked to emergency dept and separate entry

PICU - 10 beds + 2 x seclusion rooms

General acute – 2 x 22 bed units

Substance Use Unit (drug and alcohol) – 22 beds (12 + 10)

Older persons' unit (special mental health unit for older people – SMHOP) - 6 x bed intensive care + 2 x 8 bed general (22) – not intended as a dementia unit.

Opened mid 2009

Architect = Suturs Architects PTW

Contractor = Abigroup





010101011110100100001  
0101101011100



**UNSW**  
THE UNIVERSITY OF NEW SOUTH WALES

**BUILT  
ENVIRONMENT**

Centre for Health Assets Australasia





010101011110100100001  
0101101011100



UNSW  
THE UNIVERSITY OF

BUILT

Centre for Health Assets Australasia

chaa





010101011110100100001  
0101101011100

UNSW  
f|b|e

Centre for Health Assets Australasia

chaa



010101011110100100001  
0101101011100



**UNSW**  
THE UNIVERSITY OF NEW SOUTH WALES

**BUILT  
ENVIRONMENT**

Centre for Health Assets Australasia

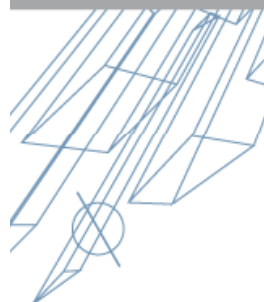



010101011110100100001  
0101101011100

UNSW  
f|b|e

Centre for Health Assets Australasia



## Mater MHU – courtyard





010101011110100100001  
0101101011100



**UNSW**  
THE UNIVERSITY OF NEW SOUTH WALES

**BUILT  
ENVIRONMENT**

Centre for Health Assets Australasia



**Mater MHU – courtyard  
fences**

010101011110100100001  
0101101011100

UNSW  
f|b|e

Health Assets Australasia



Entry



010101011110100100001  
0101101011100



**UNSW**  
THE UNIVERSITY OF NEW SOUTH WALES

**BUILT  
ENVIRONMENT**

Centre for Health Assets Australasia

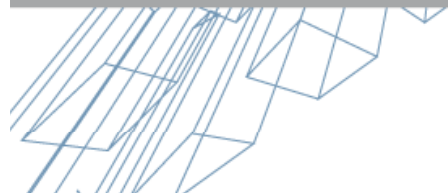

**PEC**





010101011110100100001  
0101101011100

UNSW  
f|b|e

Centre for Health Assets Australasia



## Living area and typical bedroom



010101011110100100001  
0101101011100



**UNSW**  
THE UNIVERSITY OF NEW SOUTH WALES

**BUILT  
ENVIRONMENT**

Centre for Health Assets Australasia



## Older persons' unit





010101011110100100001  
0101101011100

UNSW  
f|b|e

Centre for Health Assets Australasia



010101011110100100001  
0101101011100



**UNSW**  
THE UNIVERSITY OF NEW SOUTH WALES

**BUILT  
ENVIRONMENT**

Centre for Health Assets Australasia



## External views



010101011110100100001  
0101101011100



**UNSW**  
THE UNIVERSITY OF NEW SOUTH WALES

**BUILT  
ENVIRONMENT**

Centre for Health Assets Australasia



# **CENTRE FOR HEALTH ASSETS AUSTRALASIA\***

## **Australasian Health Facility Guidelines Project**

**[www.healthfacilityguidelines.com.au](http://www.healthfacilityguidelines.com.au)**

Website: [www.chaa.net.au](http://www.chaa.net.au)

Email: [chaa.admin@unsw.edu.au](mailto:chaa.admin@unsw.edu.au)

Tel: +61 2 9385 5619    Fax: +61 2 9385 5935

\*We acknowledge our major sponsors who include the Australasian Health Infrastructure Alliance (AHIA) and the University of NSW